

EC300/310/320/321/322 Series Installation Guide

Package Contents

- ☑ 1 System unit
- ☑ 1 SATA data/power cable
- ☑ 1 120W power adapter (-CR6G60/-CRA060/-CR6881)
- ☑ 1 160W power adapter (-CR4866)
- ☑ 1 Installation Guide
- ☑ 1 CD disk includes:
 - Drivers
 - Manual

Optional Items

- ☑ 1 Wallmount kit
- ☑ 1 Power cord
- ☑ 1 3G

System Models

Rear I/O Ports	EC3xx- CR6881	EC3xx- CR6G60	EC3xx- CRA060	EC300/320/321/ 322-CR4G65	EC3xx-CR4866
DC-in power jack: 3-pole terminal block	1	1	1	1	1
Speaker-out: 2W 3.5mm audio jack	1	1	1	1	1
VGA: DB-15 D-sub	1	1	1	1	1
DVI (DVI-D signal)	1	0	0	0	0
Gigabit LAN: RJ45 with LEDs	2	2	2	5	2
PoE Gigabit LAN: RJ45	0	0	0	0	4
COM: DB-9 D-sub (RS232/422/485)	6	6	4	4	4 (2 ports are RS232.)
COM: 5-pole terminal block (RS232/422/485)	0	0	6	0	0
USB 3.0 Type A	2	2	2	2	2
USB 2.0 Type A	2	0	0	0	0
GPIO: 9-pole terminal block	8-bit	16-bit	0	16-bit	8-bit
Reset button	1	1	1	1	1
Power LED	1	1	1	1	1
HDD LED	1	1	1	1	1
Alert LED	1	1	1	1	1
Front I/O Ports	EC3xx- CR6881	EC3xx- CR6G60	EC3xx- CRA060	EC300/321- CR4G65	EC3xx-CR4866
USB 2.0 Type A	4	4	4	4	4
Power button with indicator	1	1	1	1	1
Reset button	1	1	1	1	1
HDD LED	1	1	1	1	1
Alert LED	1	1	1	1	1
Wi-Fi module antenna hole	2	2	2	2	2

Installing a SATA Drive

1. Locate the SATA drive bay on the cover.

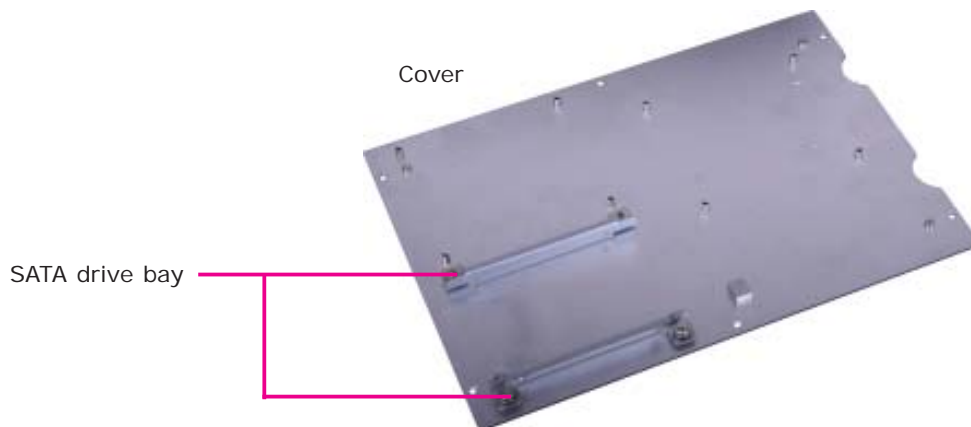

2. Remove the 4 mounting screws that secure the HDD brackets to the drive bay.

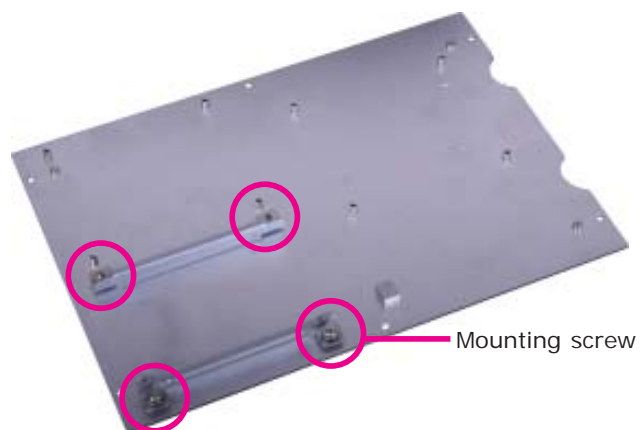

3. Align the mounting holes of the SATA drive with the mounting holes on the HDD bracket and then use the provided mounting screws to secure the drive in place.

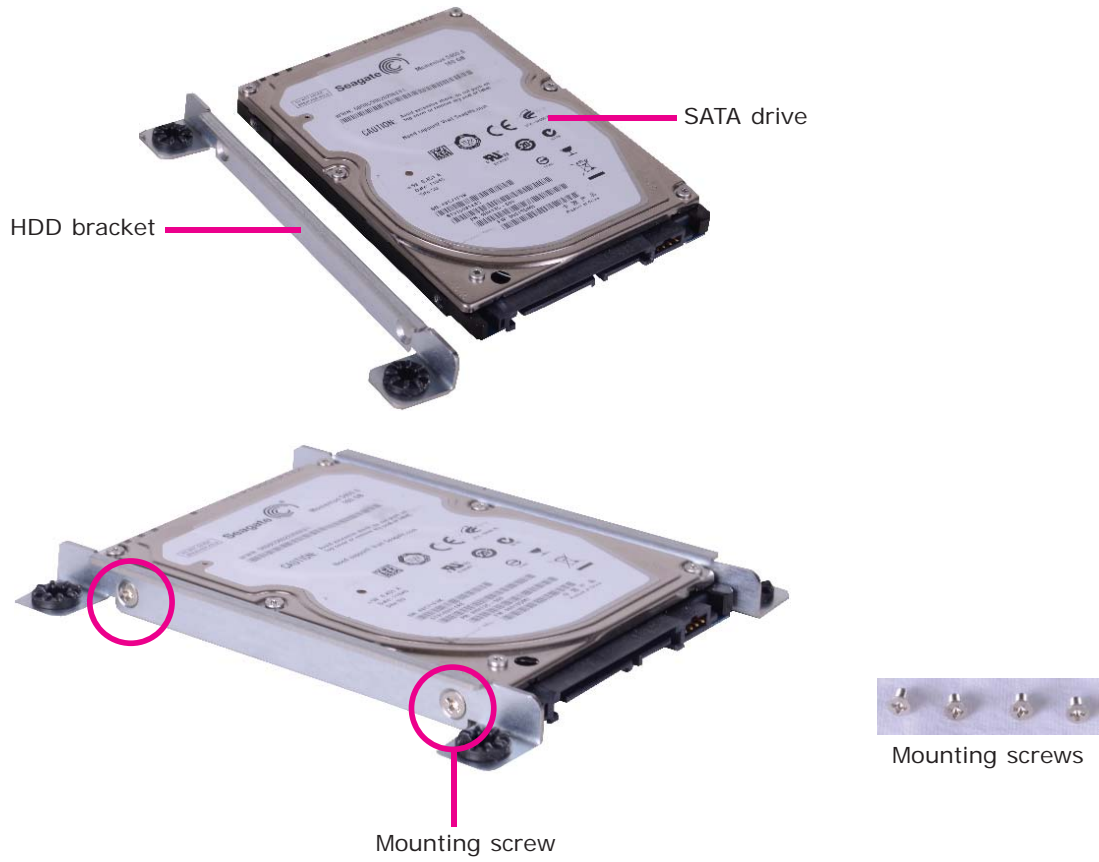

4. Place the SATA drive (with HDD bracket) into the cover. Align the mounting holes on the HDD bracket with the mounting holes on the SATA drive bay and then use the provided mounting screws to secure the drive in place.

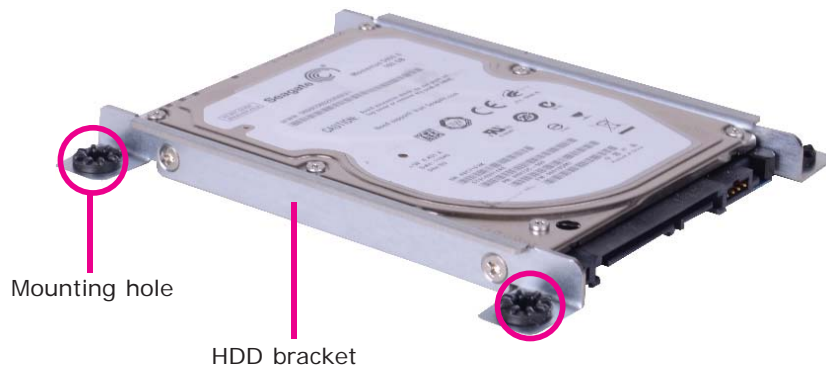

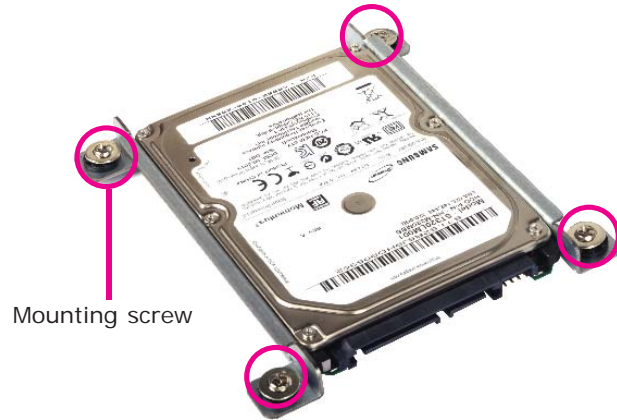
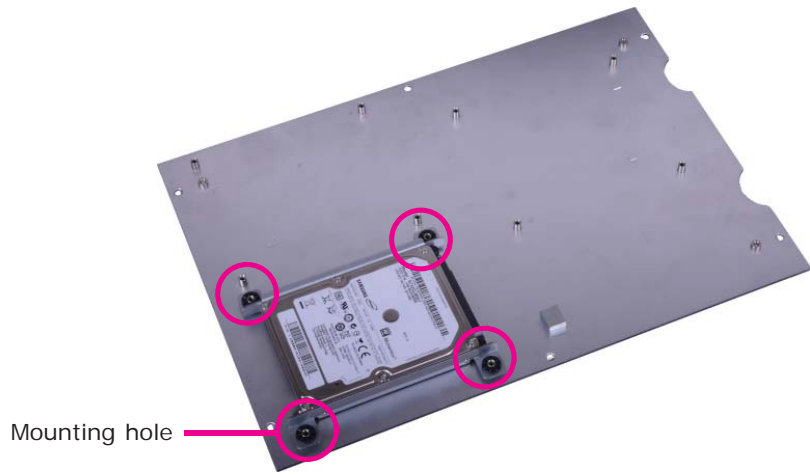

5. Connect A to the SATA power/data connector on the SATA drive, B and C to the SATA power connector and SATA data connector respectively on the system board.

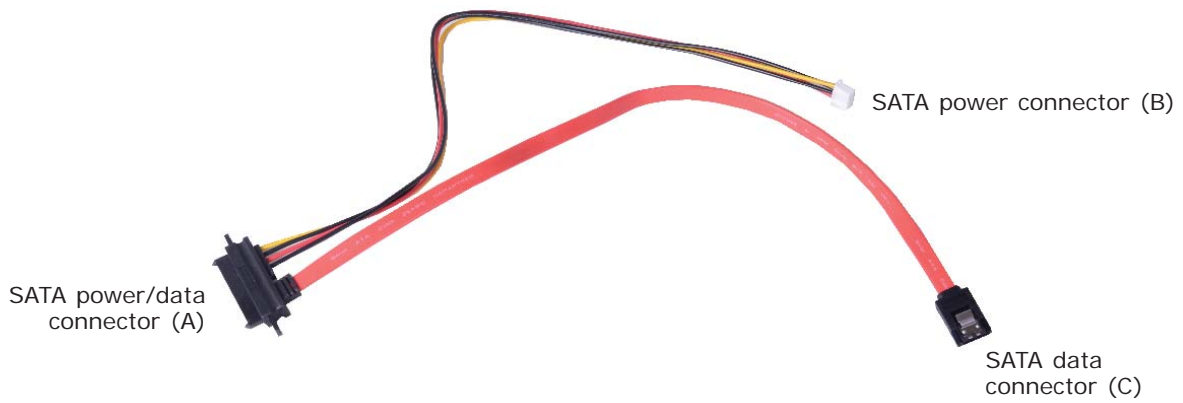



SATA power/data connector

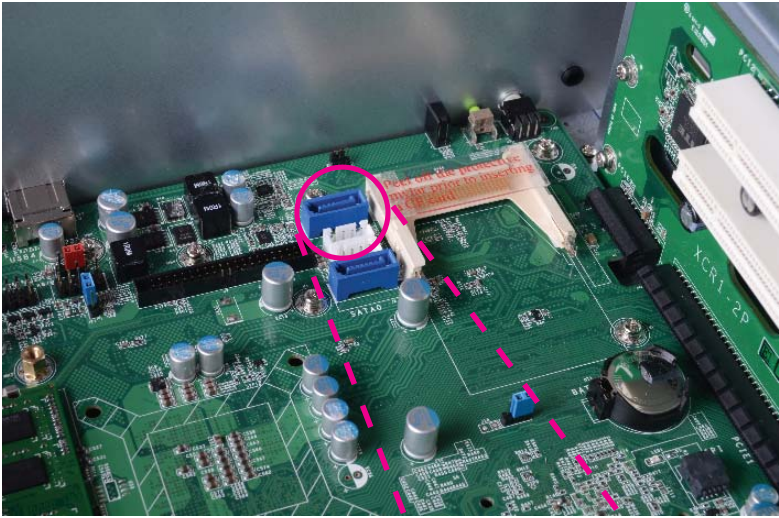

SATA data connector

SATA power connector

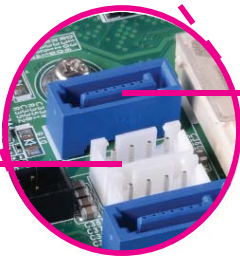

System Boards and Jumper Settings

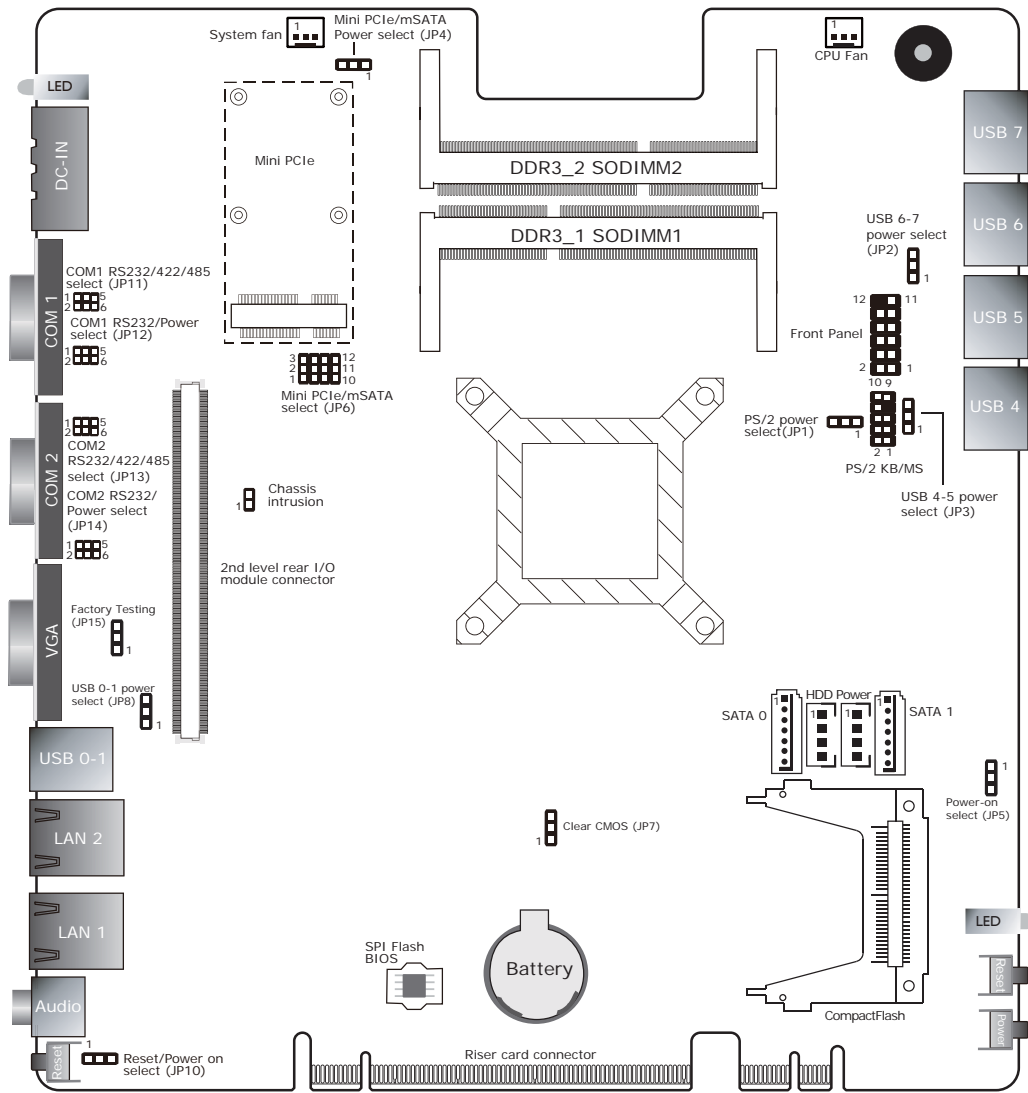

Clear CMOS Data	JP7
Normal (default)	1-2 On
Clear CMOS Data	2-3 On

PS/2 Power	JP1
+5V (default)	1-2 On
+5V_standby	2-3 On

COM1 (JP12), COM2 (JP14) RS232/Power	
RS232 (default)	1-3, 2-4 On
RS232 with power	3-5 (+12V), 4-6 (+5V) On

Mini PCIe/mSATA Power Select	JP4
3V3 (default)	1-2 On
3VDU	2-3 On

Reset/ Power on Select	JP10
Reset (default)	1-2 On
Power on	2-3 On

Power-on Select	JP5
Power-on via power button (default)	1-2 On
Power-on via AC power	2-3 On

USB Power: 0-1 (JP8), 4-5 (JP3), 6-7 (JP2)	
+5V (default)	1-2 On
+5V_standby	2-3 On

COM1 (JP11), COM2 (JP13) RS232/RS422/RS485 Select	
RS232 (default)	1-2 On
RS422 Full Duplex	3-4 On
RS485	5-6 On

Mini PCIe/mSATA Select	JP6
Mini PCIe (default)	1-2, 4-5, 7-8, 10-11 On
mSATA	2-3, 5-6, 8-9, 12-13 On

Note: The Reset/ Power on Select is used to select the function of the reset bottom.